



Você está em: Início > Projectos > IGEIA

Menu Principal

IPS

ESTSetúbal/IPS

Cursos

Alunos

Internacional

I & D

Ligação à sociedade

Pessoal

Pesquisa

Contacte-nos

Integration of Geothermal Energy into Industrial Application

Referência: 3/2006 DEM

Nome Curto: IGEIA

Tipo: Projecto Europeu

Início: 2006

Conclusão Prevista: 2009

Estado: Activo

Instituição Financiadora: Comissão Europeia

Programa: Inteligente Energy Europe

Tipo de Acção: IDT/RTD

Autenticação

Utilizador:

Senha:

Validar

Mapa da ESTSetúbal

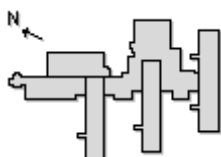

Resumo: Industrial applications constitute the smallest sector of direct geothermal energy use. The industrial sector, at least in theory, offers a very attractive target for geothermal use. Historically this has not translated into extensive use however. The project aims at helping the development of geothermal heating and cooling into industrial sites. We plan to develop geothermal applications in the industrial sector in some countries. We want to convince the industry that the geothermal energy could offer solutions to its energy problems. The following are the objectives of this proposal: • Identify energy needs from the industrial sector. Investigate industrial sites that permit the use of geothermal application and evaluate its energy usage • Presentation of local conditions permitting to install geothermal heating. Identify new energy savings in heating & cooling on sites. • Feasibility Study of the geothermal application • Develop a European solution customized by country • Inform the industrial sector on geothermal potential and its advantages (everywhere, everytime...)

Pessoas no Projecto

Nome	Nome Curto	Função	Dedicação (%)	Responsável
<u>Luís Coelho</u>	LCo	Não Definido		S

Página gerada em: 2008-06-30 às 11:31:14